

S01 SECTION DETAIL
Scale: 1:1

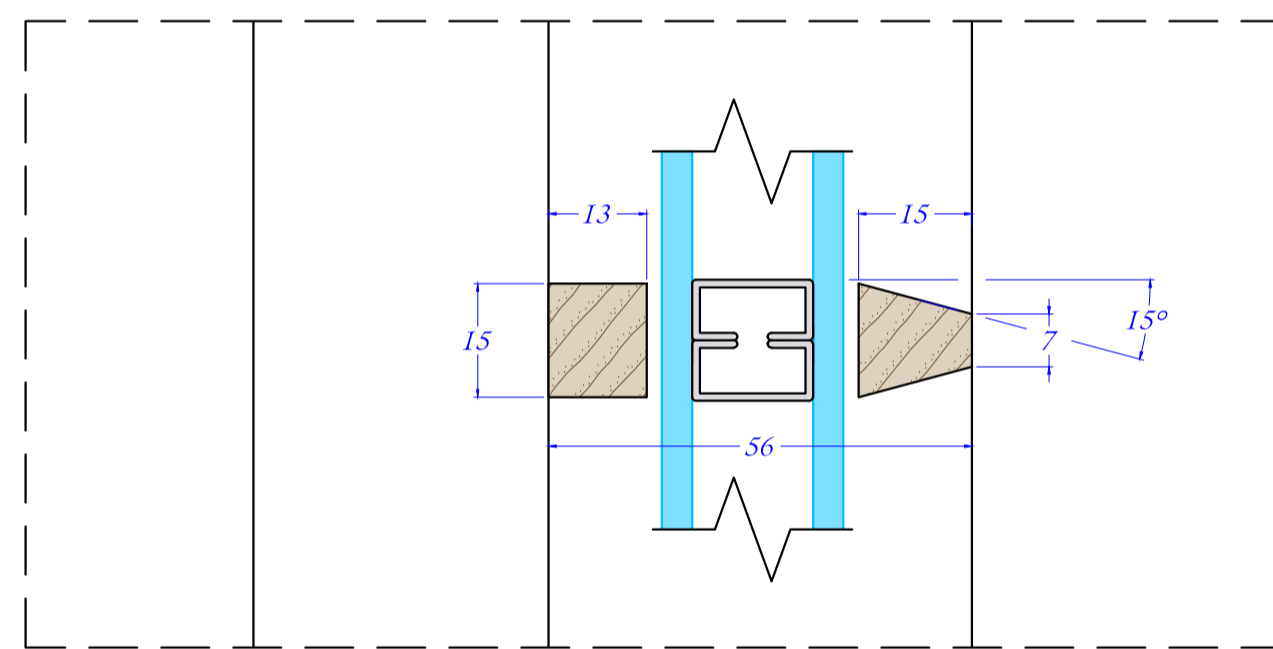

S02 SECTION DETAIL
Scale: 1:1

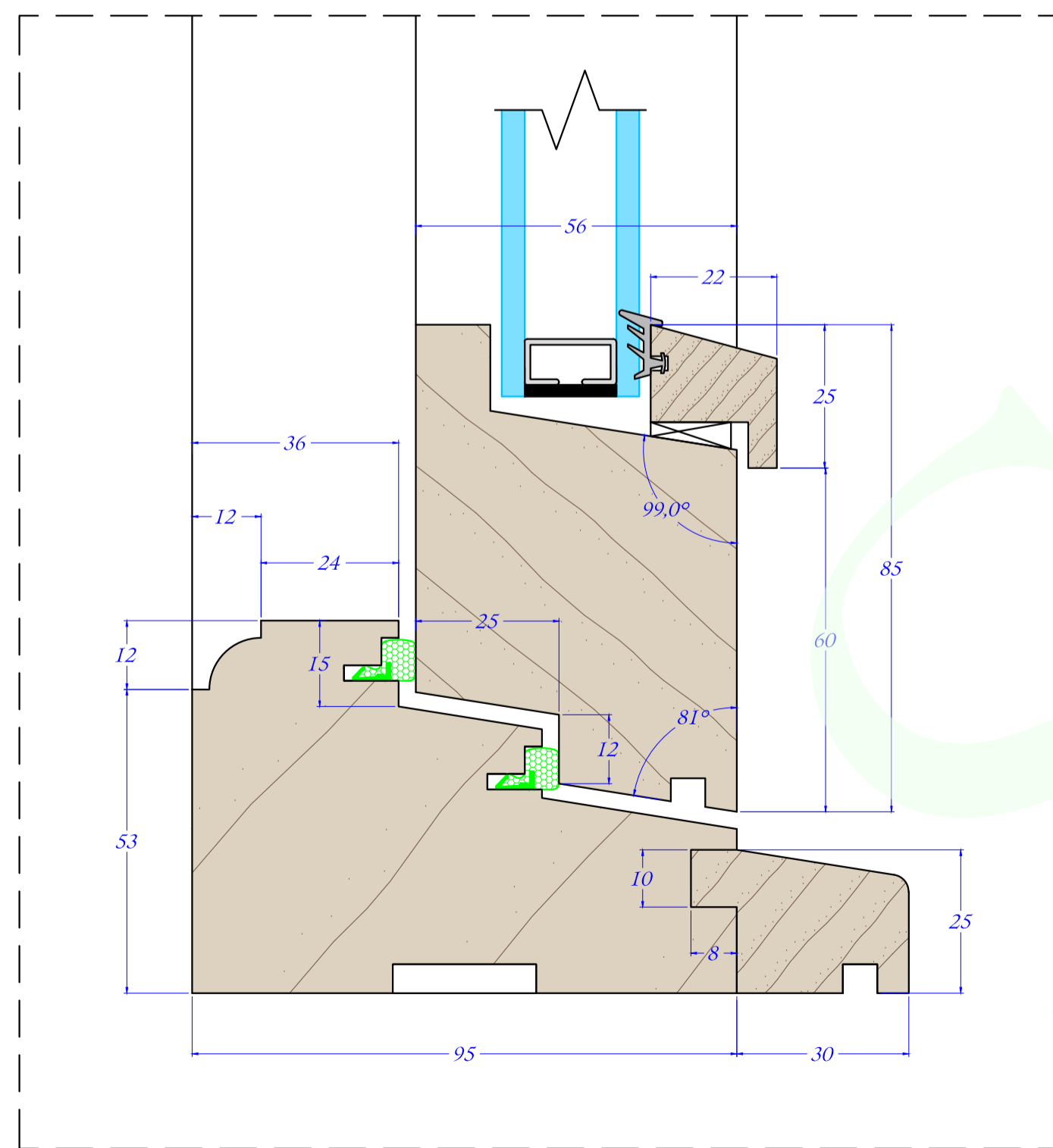

S03 SECTION DETAIL
Scale: 1:1

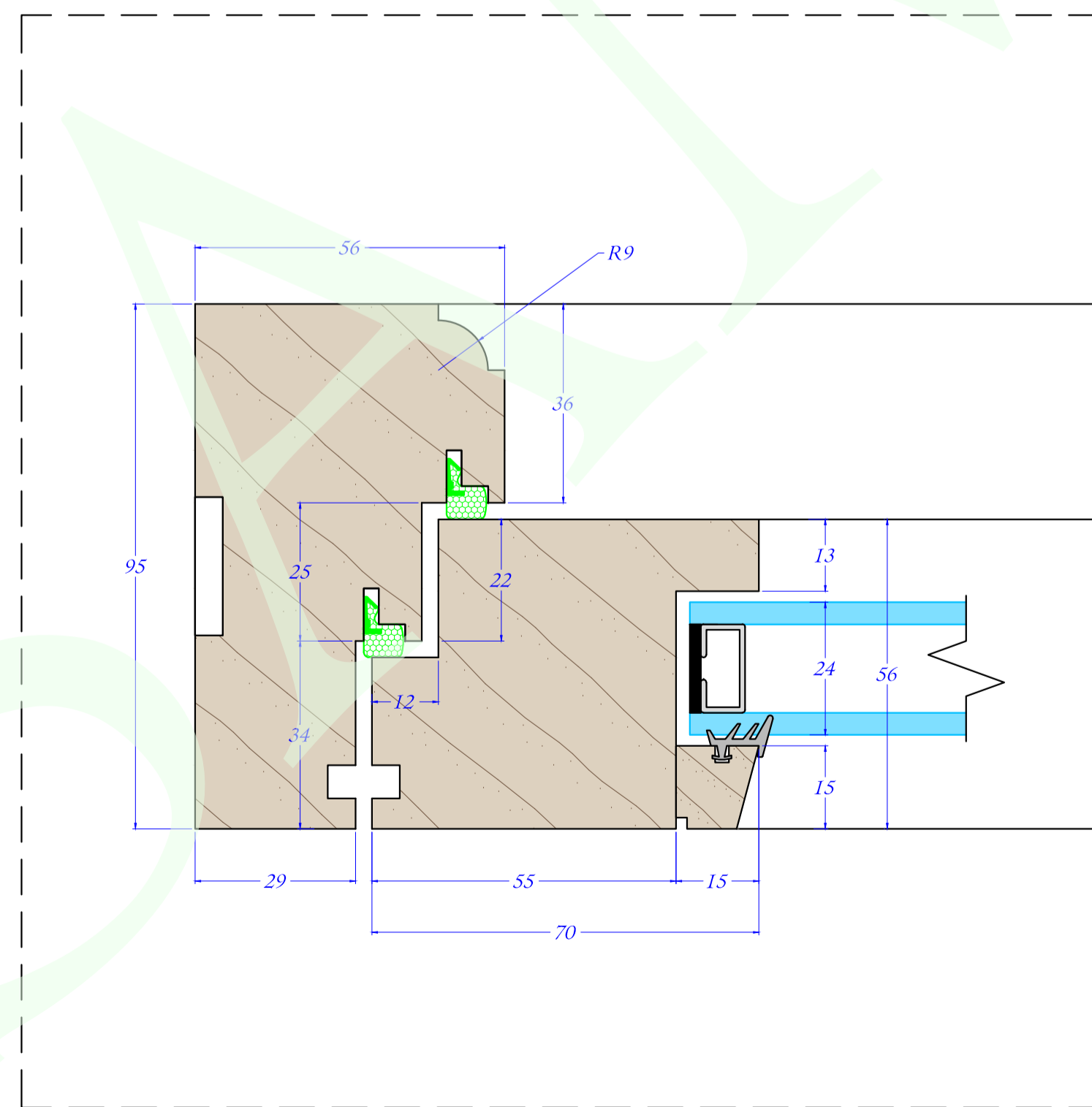

S04 SECTION DETAIL
Scale: 1:1

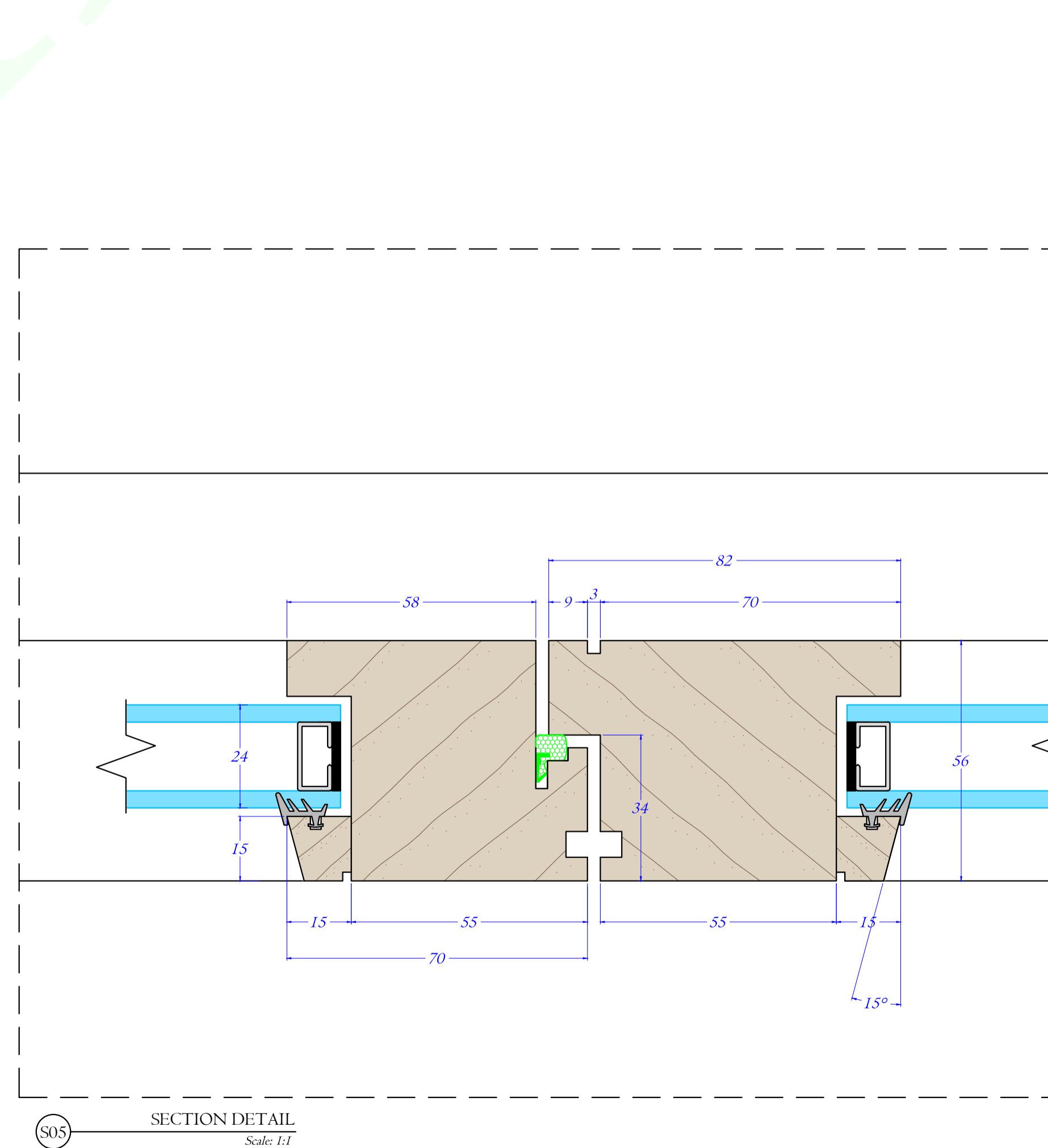
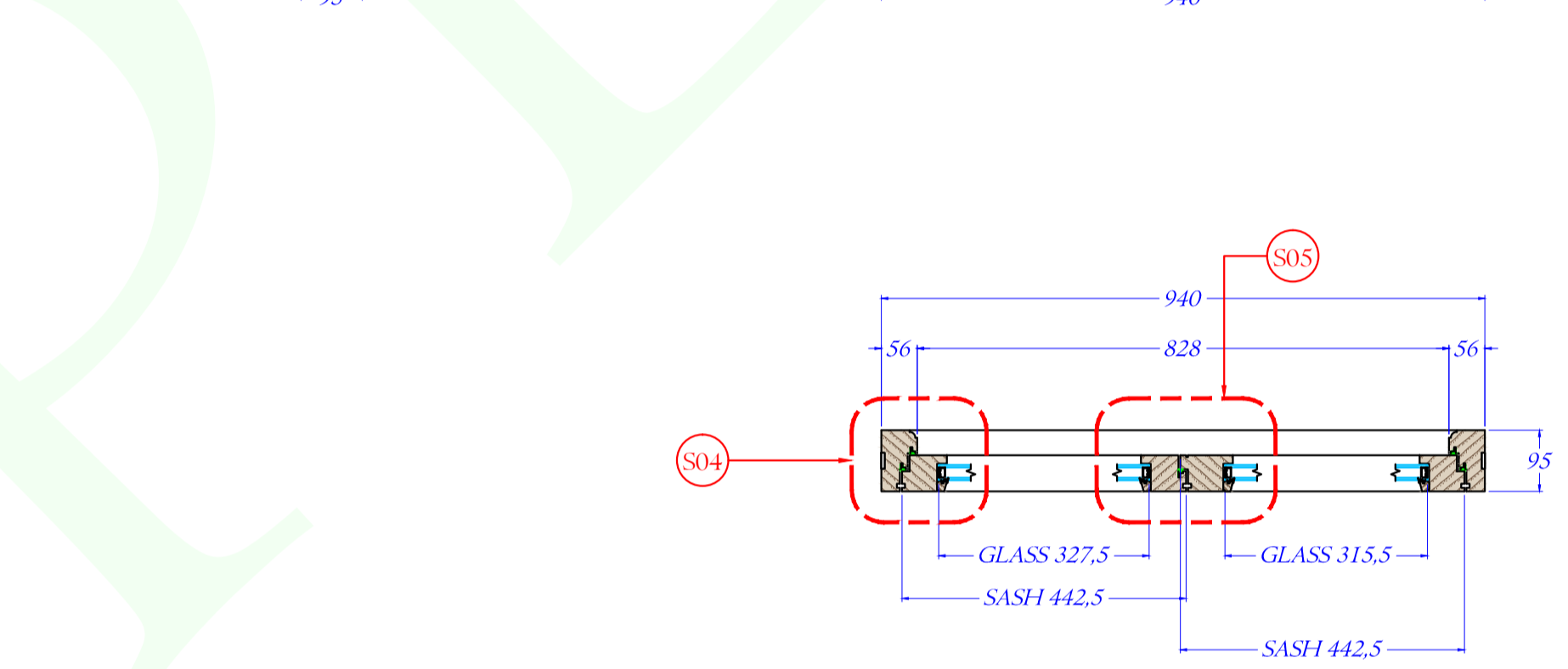
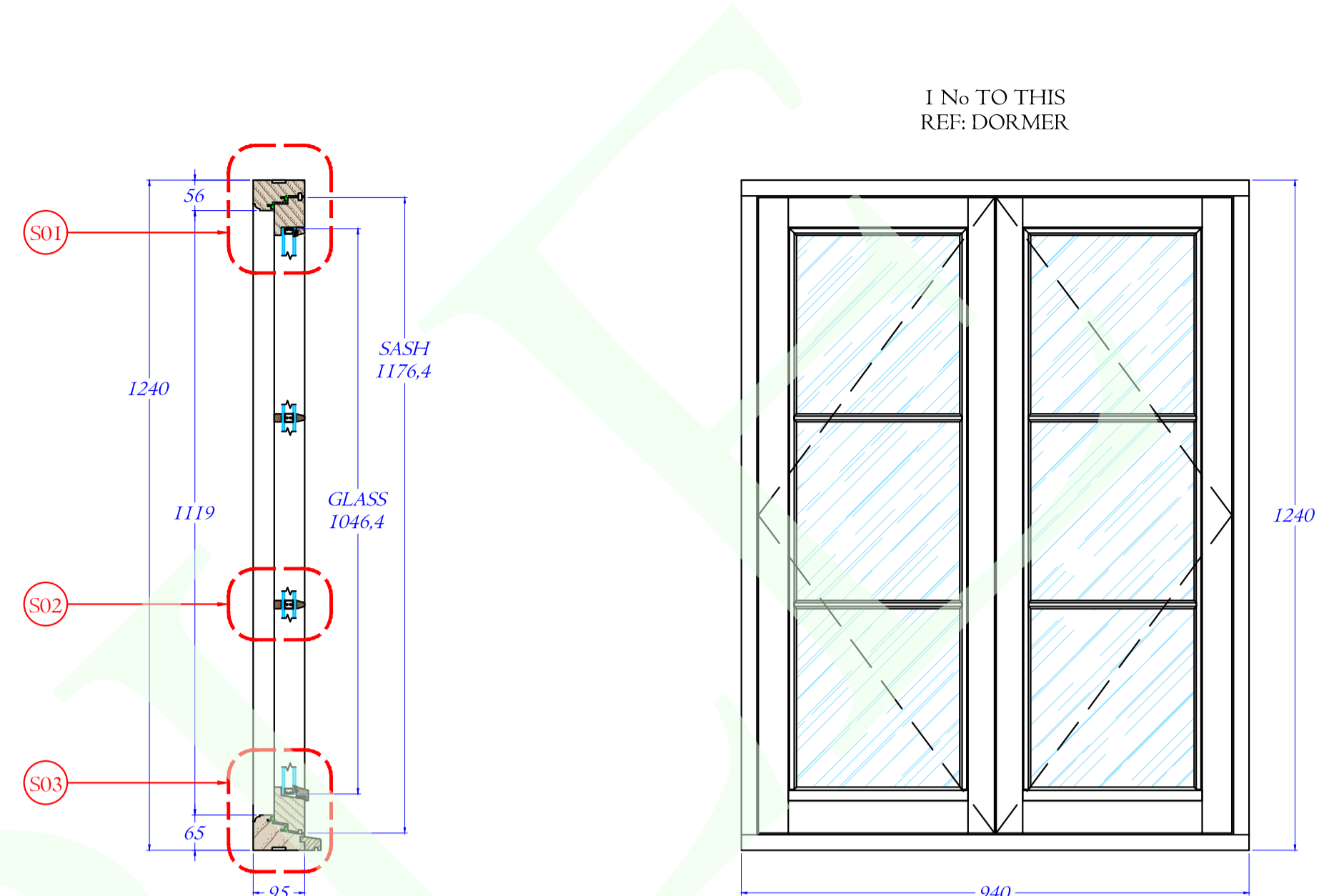

S05 SECTION DETAIL
Scale: 1:1

1 No TO THIS
REF: DORMER

1. This drawing has been prepared to cover matters which are the requirements of the Company listed below and do not constitute a full specification of the work.
2. All dimensions, details, components, and assemblies are to be verified by the Contractor PRIOR to construction, manufacture or supply.
3. Any conflicting information, errors or omissions shown or implied on this drawing shall be referred to the Contractor PRIOR to construction or ordering of materials.
4. Do not scale this drawing.
5. This drawing is the Copyright of Joinery Cad Solutions Ltd and may not be copied in part or whole without written permission.

REVISIONS :

| | | |
|---|------------|--------------------------|
| ~ | 31.07.2017 | FIRST ISSUE FOR APPROVAL |
|---|------------|--------------------------|

- SPECIFICATIONS :
- MATERIAL:
- HARDWOOD THROUGHOUT
 - ARCHITRAVE FROM WRP MOULDINGS REF: A936
- GLASS:
- 4 16, 4 CLEAR TOUGHENED DG UNITS
 - BLACK WARM EDGE SPACER
 - ARGON GAS FILLED
 - EXTERNALLY DRY BEAD GLAZED
- HARDWARE:
- SATIN CHROME NON LOCKING HANDLE REF: TBC
 - HINGES TBC
 - RESTRICTOR TBC
 - AQUAMAC 63 WHITE WEATHERSEALS
- FINISH:
- FULL FACTORY PAINT FINISHED WHITE
- NOTES:
- CLIENT TO CONFIRM DESIGN PRIOR TO MANUFACTURE

4 Hours
To Complete

SAMPLE

| | |
|-------------|---|
| CLIENT | ---- |
| PROJECT | ---- |
| TITLE | FIRE ESCAPE DORMER CONSTRUCTION DETAIL |
| ISSUE | CLIENT APPROVAL |
| JOB No | ---- |
| DRAWING No | ----/001 |
| CUT LIST No | |
| SCALE | 1:1, 1:10 @ A1 |
| DRAWN BY | JCS |
| CHECKED BY | REV ~ |